



**EXPANDERS**  
**ACCESSORIES**  
**MISCELLANEOUS ITEMS**  
**STEPS & TROLLEYS**

[www.atlashandlinguk.co.uk](http://www.atlashandlinguk.co.uk)  
01527 501 148



# SCENE SHIFTERS

## SERIES: ICSKATE

BRACKET: **FABRICATED**  
BEARING: **PLAIN/BALL BEARING**



WHEELS

### ICSKATE

#### SWIVEL

##### NYLON

ICS/50NB2LLNY	50	14		135x110	105x80	10	95	300
ICS/100DRHBH12NYBJ	100	35		135x110	105x80	13	163	460
ICS/125DRHBH12NYBJ	125	35		135x110	105x80	13	183	460

##### STEEL

ICS/50NB2LLST	50	14		135x110	105x80	10	95	300
---------------	----	----	--	---------	--------	----	----	-----

##### BLUE ELASTICATED

ICS/100DRHBH12BNB	100	36		135x110	105x80	13	163	460
ICS/125DRBH12BNB	125	36		135x110	105x80	13	183	460

##### CAST IRON

ICS/100DRHBH12CIBJ	100	36		135x110	105x80	13	163	460
ICS/125DRHBH12CIBJ	125	38		135x110	105x80	13	183	460

##### POLY ALUMINIUM

ICS/100DRHBH12PTABJ	100	40		135x110	105x80	13	163	460
ICS/125DRHBH12PTABJ	125	40		135x110	105x80	13	183	460

##### POLY CAST IRON

ICS/35NBLL2PTBJ	35	28		85x85	55x55	10	85	300
ICS/50NB2LLPT	50	14		135x110	105x80	10	95	300
ICS/100DRHBH12PTBJ	100	38		135x110	105x80	13	163	460
ICS/125DRHBH12PTBJ	125	38		135x110	105x80	13	183	460

##### RUBBER CAST IRON

ICS/100DRHBH12RTBJ	100	36		135x110	105x80	13	163	460
ICS/125DRHBH12RTBJ	125	38		135x110	105x80	13	183	460



### PLATE OPTIONS

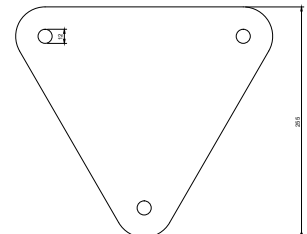
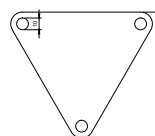
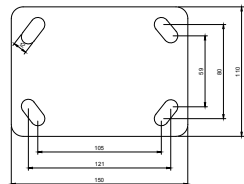
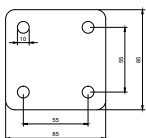

# PALLET ROLLERS

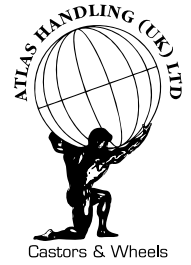

## PALLET ROLLERS NYLON OR POLYURETHANE

Pallet Rollers are specifically designed as replacement pallet rollers on pallet trucks and fork lift trucks. With an extra wide tread and ball journal bearings these durable and robust hardworking pallet rollers can take loads of up to 950k.

With a variety of pallet roller wheel diameters to suit your requirements in either polyurethane or nylon.



### NYLON

<b>82x60WNYBJM</b>	82	60		17/20/25	60	600
<b>82x70WNYBJM</b>	82	70		17/20/25	70	700
<b>82x100WNYBJM</b>	82	100		17/20/25	100	1000
<b>85x60WNYBJ</b>	85	60		17/20/25	60	600
<b>85x70WNYBJ</b>	85	70		17/20/25	70	700
<b>85x90WNYBJ</b>	85	90		17/20/25	90	900
<b>85x100WNYBJ</b>	85	100		17/20/25	100	1000



### POLYURETHANE

Polyurethane on Nylon

<b>82x70WPNBJ</b>	82	70		17/20/25	70	500
<b>82x100WPNBJ</b>	82	100		17/20/25	100	850
<b>85x90WPNBJ</b>	85	90		17/20/25	90	750



### POLYURETHANE

Polyurethane on Cast Iron

<b>70x70WPTBJM</b>	70	70		15	70	500
<b>75x75WPTBJM</b>	75	75		17/20/25	75	570
<b>80x60WPTBJM</b>	80	60		17/20/25	60	550
<b>82x60WPTBJM</b>	82	60		17/20/25	60	600
<b>82x70WPTBJM</b>	82	70		17/20/25	70	700
<b>82x75WPTBJM</b>	82	75		17/20/25	75	750
<b>82x90WPTBJM</b>	82	90		17/20/25	90	900
<b>82x100WPTBJM</b>	82	100		17/20/25	100	1000
<b>85x60WPTBJM</b>	85	60		17/20/25	60	700
<b>85x70WPTBJM</b>	85	70		17/20/25	70	700
<b>85x75WPTBJM</b>	85	75		17/20/25	75	750
<b>85x80WPTBJM</b>	85	80		17/20/25	80	800
<b>85x90WPTBJM</b>	85	90		17/20/25	90	900
<b>85x100WPTBJM</b>	85	100		17/20/25	100	1000

## EXPANDERS & ACCESSORIES

### EXPANDERS



ES	INSIDE-TUBE MEASUREMENT	TUBE
Square Expander		
ES21.5	19-21.5	SQUARE
ES24	21.5-24	SQUARE
ES27	24-27	SQUARE
ES30	27-30	SQUARE
ES35	32-35	SQUARE
ES40	36-40	SQUARE



ER	INSIDE-TUBE MEASUREMENT	TUBE
Round Expander		
ER21.5	19-21.5	ROUND
ER24	21.5-24	ROUND
ER27	24-27	ROUND
ER30	27-30	ROUND
ER35	32-35	ROUND
ER40	36-40	ROUND



### ACCESSORIES

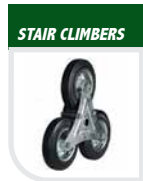

### SPRING LOADED GATE CASTOR

SPECIAL PURPOSE CASTOR SPECIFICALLY DESIGNED TO HELP SUPPORT THE ENDS OF WIDE SWING GATES OR DOORS, HELPING REDUCE STRESSES AND STRAINS ON SUPPORTS AND HINGES, AND AID SMOOTHER OPERATION. THEY WILL PROVIDE UP TO 70KG OF SUPPORT AND CAN ACCOMMODATE A MAXIMUM OF 75MM/3" OF UPWARDS COMPRESSION/GROUND HEIGHT VARIATION.

### KEY DIMENSIONS



Side Elevation

Fixing Plate

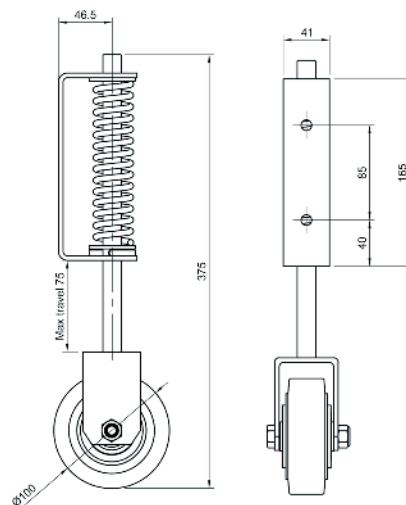



## ADJUSTABLE FEET



## ADJUSTABLE FEET

### MILD STEEL BRIGHT ZINC PLATE STEMS WITH PLASTIC BASES

STEMS: MILD STEEL BZP BASES: POLYPROPYLENE



**25MM TO 55MM**  
**80MM TO 105MM**  
**STEMS**  
**BASES**  
**WEIGHT**

CONICAL ONLY  
CONICAL OR BOLT DOWN  
MILD STEEL BRIGHT ZINC PLATE STEMS  
POLYPROPYLENE  
50KG - 450KG

### STAINLESS STEM & PLASTIC BASES

STEMS: STAINLESS STEEL BASES: POLYPROPYLENE BLACK OR WHITE



**25MM TO 55MM**  
**80MM TO 105MM**  
**STEMS**  
**BASES**  
**WEIGHT**

CONICAL ONLY  
CONICAL OR BOLT DOWN  
STAINLESS STEEL  
POLYPROPYLENE BLACK OR WHITE  
50KG - 450KG

### SOLID STAINLESS STEEL STEMS & BASES

STEMS: STAINLESS STEEL BASES: STAINLESS STEEL



**38MM TO 76MM**  
**76MM TO 102MM**  
**STEMS**  
**BASES**  
**WEIGHT**

CONICAL ONLY  
CONICAL OR BOLT DOWN  
STAINLESS STEEL  
STAINLESS STEEL  
300KG - 2000KG

ADJUSTABLE FEET



## STEPS / STEP TRAY TROLLEYS

### STEP LADDERS

All classic models are fully welded throughout and available with ribbed rubber or anti-slip treads.

Close fitting continuous single rail guard around top platform, extending down each side of stairway as a short handrail.

Fitted with dome covered spring loaded, 50mm dia swivel castors which retract when weight is applied to the steps, giving them firm contact with the floor.

Grey non marking tyres.

Dome covers have a double rolled bottom edge together with a protective cover strip, giving a neat appearance and reasonable protection to carpets and other floor surfaces.

Spiggot OD 18.5mm\*

Spiggot Length 85mm

Fixing Hole dia: 5mm

Fixing hole centre from base of tube 10mm

The I/D of the tube on the step itself that we have is 24.1mm\* so there is a fair amount of clearance / tolerance.



TREAD (INC PLATFORM)	2	3	4	5
<b>AVERAGE WORKING HEIGHT</b>	2.00M	2.26M	2.52M	2.77M
<b>PLATFORM HEIGHT MM</b>	508	762	1016	1270
<b>PLATFORM WIDTH MM</b>	380	380	380	380
<b>PLATFORM DEPTH MM</b>	280	280	280	280
<b>O/ALL H (INC RAILS)MM</b>	1185	1425	1683	1940
<b>O/ALL WIDTH MM</b>	580	580	580	580
<b>O/ALL DEPTH MM</b>	540	795	955	1120
<b>WEIGHT KGS</b>	12	14	17	20
<b>RIBBED RUBBER TREADS REF</b>	<b>S005</b>	<b>S009</b>	<b>S011</b>	<b>S013</b>
<b>ANTI SLIP TREADS REF</b>	<b>S006</b>	<b>S010</b>	<b>S012</b>	<b>S014</b>

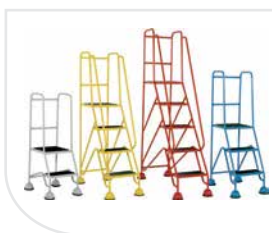

TREAD (INC PLATFORM)	2	2	2	3	4	5
<b>HANDRAILS</b>	NONE	SINGLE	FULL	FULL	FULL	FULL
<b>PLATFORM HEIGHT MM</b>	508	508	508	762	1016	1270
<b>PLATFORM WIDTH MM</b>	406	406	406	406	406	406
<b>PLATFORM DEPTH MM</b>	380	380	380	380	380	380
<b>O/ALL H (INC RAILS)MM</b>	570	1175	1175	1430	1680	1935
<b>O/ALL WIDTH MM</b>	556	556	556	556	556	556
<b>O/ALL DEPTH MM</b>	650	650	650	790	1005	1225
<b>WEIGHT KGS</b>	7	9	11	14	17	20
<b>RIBBED RUBBER TREADS REF</b>	<b>S218</b>	<b>S220</b>	<b>S221</b>	<b>S222</b>	<b>S223</b>	<b>S224</b>
<b>ANTI SLIP TREADS REF</b>	<b>S219</b>	<b>S225</b>	<b>S226</b>	<b>S227</b>	<b>S228</b>	<b>S229</b>

# HOOF & STEPS



## STEP TRAY TROLLEYS



### 3 Step, 3 Tray Tiers

Spring loaded step unit, with ribbed rubber treads, locates firmly on floor when foot placed on first step, immobilising trolley.

Top tread height 686mm

Fully welded construction, from RSA angle and ERW tube. Rubber feet fitted to step unit. Blue Epoxy finish.



### 5 Step, 3 Tray Tiers

Fully welded from RSA angle and ERW tubes.

Fitted with 2 retractable castors in front and 2 fixed castors to rear, each with 125mm rubber tyred wheels and roller bearings.

Front castors retract with hand operated lever to immobilise trolley. Fixed steps, handrail fitted to each side and across the top.

## HOOF CASTOR

Hoof Cup Feet steps are mounted on retractable spring castors to enable the steps to be easily moved into position. When under the operator weight steps lower to grip the floor.

Spigot OD 18.5mm\*

Spigot Length 85mm

Fixing Hole dia: 5mm

Fixing hole centre from base of tube 10mm

The I/D of the tube on the step itself that we have is 24.1mm\* so there is a fair amount of clearance / tolerance!





## TRAY TROLLEYS

### CLASSIC TRAY TROLLEYS

Choice of elegant and smart removable and reversible white or blue trays in blue frame, or fixed ply shelves. Tough durable epoxy finish throughout.

2 or 3 removable steel trays or fixed ply shelves.	125mm dia.
Removable and reversible steel trays for flush or recessed fitting.	Stem fitting castors.
Welded tube and angle construction.	Grey non marking tyres with thread guards.
Overall height 1065mm.	Max load: 200kg



NO. OF TRAYS	2-TRAYS		3-TRAYS	
<b>TRAY SIZE L X W MM</b>	760 x 457	2.00M	2.00M	2.00M
<b>TRAY HEIGHTS MM</b>	245 : 945	508	508	508
<b>WEIGHT KGS</b>	25	380	380	380
<b>ICTTW SERIES REF</b>	ICTT62	ICTT66	ICTT63	ICTT67
<b>WHITE EPOXY TRAYS</b>				
<b>ICTTB SERIES REF</b>	ICTT72	ICTT76	ICTT73	ICTT77
<b>BLUE EPOXY TRAYS</b>				
<b>TT60 SERIES REF</b>	ICTT60	ICTT64	ICTT61	ICTT65
<b>FIXED PLY TRAYS</b>	20	31	27	41

### HEAVY DUTY TRAY TROLLEYS

Special heavyweight tray trolleys custom built to your specification if required. Strong construction from square and round section steel tubes and steel shelves with lip.

3 removable steel trays or fixed ply shelves.	200mm dia.
Solid rubber tyre	Red centred wheels fitted
Welded tube and angle construction.	Roller bearing.
Finish Blue epoxy.	Max load: 350kg



NO. OF TRAYS	3-TRAYS	
HEIGHT MODEL	900MM	1200MM
<b>O/A LENGTH X WIDTH X HEIGHT</b>	1090 x 500 x 900	1090 x 500 x 1200
<b>EXTERNAL TRAY SIZE L X W</b>	900 x 500	900 x 500
<b>BOTTOM SHELF HEIGHT</b>	280	280
<b>MIDDLE SHELF HEIGHT</b>	590	740
<b>TOP SHELF HEIGHT</b>	900	1200
<b>WEIGHT KGS</b>	56	58
<b>REF</b>	<b>ICTT34</b>	<b>ICTT35</b>



# TABLE TRUCKS



## TABLE TRUCKS

Ideal truck series for tough work in Stores, Warehouses, Factories and Workshops.

Welded steel construction throughout.	Wheels: 2 fixed 2 swivel castors
Overall length = Deck length + 135mm	200mm dia. Rubber tyred wheels.
Overall width = Deck width + 20mm	Max load: 500kg
Finish: Blue epoxy.	

### RECESSED DECK OPTION

Recessed top and bottom decks optional at no extra cost.  
Add suffix RD to chosen Ref.



DECK SIZE	1000 X 600MM		1000 X 700MM		1200 X 800MM	
TYPE	TOP DECK ONLY	TOP AND BOTTOM DECK	TOP DECK ONLY	TOP AND BOTTOM DECK	TOP DECK ONLY	TOP AND BOTTOM DECK
TIMBER DECK REF WEIGHT KGS	ICTT205T 42	ICTT200T 52	ICTT230T 46	ICTT210T 56	ICTT240T 53	ICTT220T 66
STEEL DECK REF WEIGHT KGS	ICTT205S 40	ICTT200S 48	ICTT230S 44	ICTT210S 52	ICTT240S 50	ICTT220S 64



# NARROW AISLE SHELF TRUCKS

## SHELF TRUCKS

Ideal for Warehouses, Stores, Supermarkets, Factories, Offices. 1,2,3 and 4 deck models.

Overall Length x Width: 1070 x 600mm	High quality red epoxy coated finish tubular chassis frame.
Overall Height: 1,2 & 3 deck models: 1160mm	2 fixed 2 swivel castors with 160mm dia. Rubber tyred wheels with bright steel centres. Brakes optional.
Overall Height 4 deck model: 1500mm	Bright zinc plated mesh infill panels as required.
Deck Length x Width 1000 x 600mm	Fixed timber shelves with bright steel protector strips on both long sides.
Smart and attractive, narrow overall width - only 600mm	



ICTT100 2 DECKS		DECKS AT: 290 : 880MM	
	COMBINATIONS	WEIGHTS KGS	REF
MODEL A	2 fixed open ends	38	ICTT100



ICTT100 3 DECKS		DECKS AT: 290 : 650 : 1010MM	
	COMBINATIONS	WEIGHTS KGS	REF
MODEL B	2 fixed open ends	46	ICTT113



ICTT100 4 DECKS		DECKS AT: 290 : 650 : 1010 : 1370MM	
	COMBINATIONS	WEIGHTS KGS	REF
MODEL C	2 fixed open ends	57	ICTT116

# BOOKLET TROLLEYS



## BOOKLET TROLLEYS

Popular design for libraries, offices, classrooms, laboratories etc.

- Popular design for libraries, offices, classrooms, laboratories etc.
- Single with flat shelves and double sided with angled shelves.
- Strong all steel construction finished in cream epoxy.
- Overall L x W: 840 x 470mm.

- Fitted with 4 swivel castors 100mm, grey non-marking tyres and thread guards.
- Available in Different colours.
- Max Load: 150kg



2 TIER	SINGLE SIDED	DOUBLE SIDED	3 TIER	SINGLE SIDED	DOUBLE SIDED
<b>O/A HEIGHT</b>	940	955	<b>O/A HEIGHT</b>	1265	1325
<b>SHELF HEIGHTS</b>	185 / 580	185 / 655	<b>SHELF HEIGHTS</b>	185 / 540 / 895	185 / 600 / 1020
<b>O/A L X W</b>	840 x 390	840 x 470	<b>O/A L X W</b>	840 x 390	840 x 470
<b>WEIGHT KGS</b>	27	35	<b>WEIGHT KGS</b>	38	46
<b>RED REF</b>	<b>ICTT24/R</b>	<b>ICTT21/R</b>	<b>RED REF</b>	<b>ICTT25/R</b>	<b>ICTT22/R</b>
<b>GREEN REF</b>	<b>ICTT24/G</b>	<b>ICTT21/G</b>	<b>GREEN REF</b>	<b>ICTT25/G</b>	<b>ICTT22/G</b>
<b>YELLOW REF</b>	<b>ICTT24/Y</b>	<b>ICTT21/Y</b>	<b>YELLOW REF</b>	<b>ICTT25/Y</b>	<b>ICTT22/Y</b>
<b>BLUE REF</b>	<b>ICTT24/B</b>	<b>ICTT21/B</b>	<b>BLUE REF</b>	<b>ICTT25/B</b>	<b>ICTT22/B</b>

- Double sided with angled shelves.
- Tubular steel frame with sheet steel shelves.
- Overall L x W x H: 880 x 550 x 1115mm
- Available in different colours.

- Fitted with 4 swivel castors 125mm grey non-marking tyres and thread guards.
- Weight: 37kg
- Max load: 250kg

